

ZONE 5 NORTH MORELAND

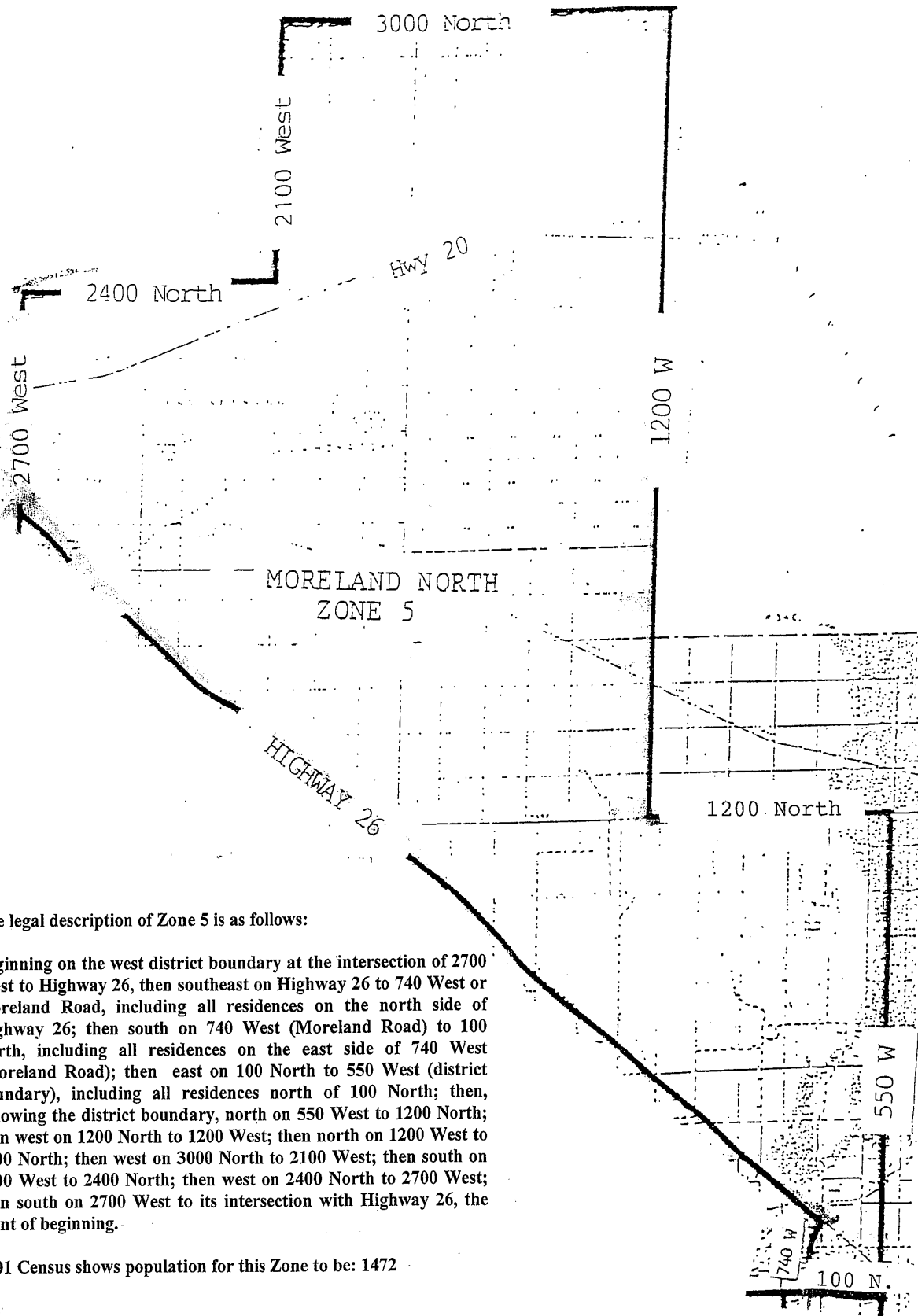

The legal description of Zone 5 is as follows:

Beginning on the west district boundary at the intersection of 2700 West to Highway 26, then southeast on Highway 26 to 740 West or Moreland Road, including all residences on the north side of Highway 26; then south on 740 West (Moreland Road) to 100 North, including all residences on the east side of 740 West (Moreland Road); then east on 100 North to 550 West (district boundary), including all residences north of 100 North; then, following the district boundary, north on 550 West to 1200 North; then west on 1200 North to 1200 West; then north on 1200 West to 3000 North; then west on 3000 North to 2100 West; then south on 2100 West to 2400 North; then west on 2400 North to 2700 West; then south on 2700 West to its intersection with Highway 26, the point of beginning.

2001 Census shows population for this Zone to be: 1472